



Bathroom Grooming & Storage Planning Book

THE BOLD LOOK
OF **KOHLER**®



Planning Tips

Now that you've decided to create a space for grooming and storage within your bathroom, what's next? Where should you begin? Once you have an idea of what you are trying to accomplish, grab a notepad, a tape measure and a sharpened pencil. Below you will find some helpful guidelines for planning your project.

Getting Started

1. Create an idea/inspiration folder.
2. Put together a prioritized list of things you need and a list of the things you want.
3. Do you plan on keeping the existing floor plan, or are you looking for a change?
4. Engage the experts – architects, general contractors, builders, bathroom designers or home improvement specialists. Discuss your ideas, needs and desires. Make sure you have some idea of probable costs and construction timeframes.
5. Sketch your design on paper.
6. Decide what work you will do yourself and what you'll hire out.
7. Set a realistic budget you can live with.
8. Consider how you will finance your project.

Access Standard

1. Choose the right vanity for your space and your needs.
 - a. KOHLER® Premier Bathroom Furniture Collections: For those who want a unified aesthetic and are looking for a comprehensive grooming and storage solution. All pieces are engineered for the bathroom, feature slow-close door and drawer hardware and offer a comfortable, ergonomic height.
 - b. KOHLER Premier Vanities: All premier vanities are engineered for the bathroom, feature slow-close door and drawer hardware and offer a comfortable, ergonomic height.
 - c. Petite Vanities: A great way to increase storage in smaller bathrooms and powder rooms, KOHLER petite vanities provide longlasting durability and sophisticated design solutions.
 - d. KOHLER Vanities with Express™ Assembly System: For those willing to perform some simple setup steps and are willing to forego some of the upgrade features that come standard on our Premier offering, like slow-close door and drawer hardware, in exchange for some cost savings, these vanities offer KOHLER sophistication and reliability.
2. Choose the right coordinating mirror.
 - a. Mirrored Cabinets: For those who are looking for some extra concealed storage space within an arm's reach, Kohler offers a wide array of styles and sizes to accommodate your needs.
 - b. Standard Mirrors: For those looking for a mirror that coordinates nicely with their bathroom's design appeal, but not needing the added storage a mirrored cabinet provides, KOHLER bathroom mirrors come in a wide variety of styles and sizes.

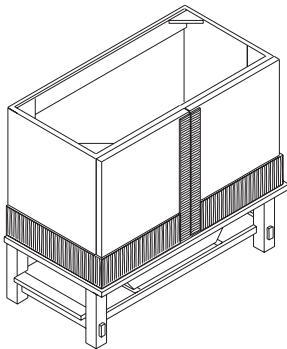

Mersing® Vanity

The exotic appeal of the Mersing vanity is achieved by combining hand-scored Bamboo and Burmese Mahogany. A translucent stain preserves the warmth of the wood, and a subtle grain texture lends a unique appearance to the vanity.

Mersing vanity
30" vanity K-2469
30" x 21³/₈" x 33¹/₂"
36" vanity K-2459
36" x 21³/₈" x 33¹/₂"
42" vanity K-2472
42" x 21³/₈" x 33¹/₂"

Bamboo and Mahogany solids and veneers

Wood Finish
Burnet (-F10)

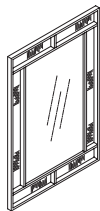

Mersing mirror
K-2460
24" x 36"

Bamboo and Mahogany solids

Coordinates with:
Iron/Impressions® cast iron one-piece surface and integrated lavatory

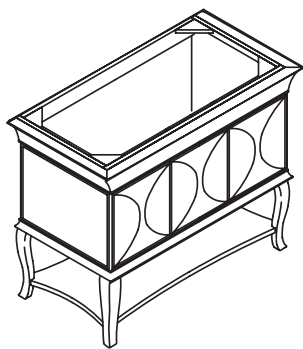

Provinity® Vanity

The Provinity vanity is comprised of European Sycamore, featuring a large, single drawer. A refined modern interpretation of the traditional Queen Anne leg lends grace and balance to the vanity.

Provinity vanity
K-2457
42" x 21³/₈" x 33¹/₂"

Sycamore solids and veneers

Wood Finish
Vellum (-F11)



Provinity mirror
K-2458
30" x 34"

Sycamore solids and veneers

Coordinates with:
Iron/Impressions® cast iron one-piece surface and integrated lavatory

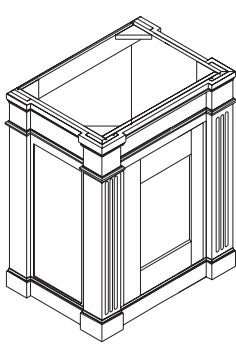

Thistledown® Vanity

Knotty Pine's unique grain has historically been used to make a refined statement in manor homes. The architectural details and subtle finish techniques of Thistledown are evocative of fine antiques.

Thistledown vanity
30" vanity K-2454
31⁹/₁₆" x 21³/₈" x 33¹/₂"
36" vanity K-2455
37⁹/₁₆" x 21³/₈" x 33¹/₂"
42" vanity K-2471
43⁹/₁₆" x 21³/₈" x 33¹/₂"

Knotty Pine solids and veneers

Wood Finish
Sienna (-F9)

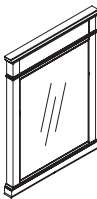

Thistledown mirror
K-2456
27¹/₂" x 37¹/₂"

Knotty Pine solids and veneers

Coordinates with:
Iron/Impressions® cast iron one-piece surface and integrated lavatory

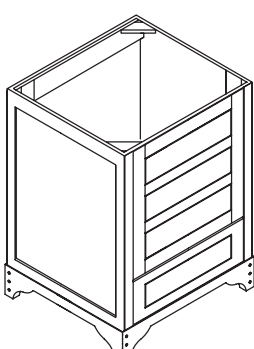

Ballard® Vanity

Portraying a classic American aesthetic, Ballard vanities are available in Clear Alder or North American White Ash veneers and solids. Raised wooden pegs, reminiscent of old-world joinery, reinforce the nostalgic appeal.

Ballard vanity
24" vanity K-2451
24³/₄" x 21³/₈" x 33¹/₂"
30" vanity K-2470
30³/₄" x 21³/₈" x 33¹/₂"
36" vanity K-2452
36³/₄" x 21³/₈" x 33¹/₂"
42" vanity K-2473
42³/₄" x 21³/₈" x 33¹/₂"

Alder or Ash solids and veneers

Wood Finishes
Nutmeg (-F7)
Seashell (-F8)

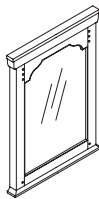

Ballard mirror
K-2453
26" x 36"

Alder or Ash solids and veneers

Coordinates with:
Iron/Impressions® cast iron one-piece surface and integrated lavatory

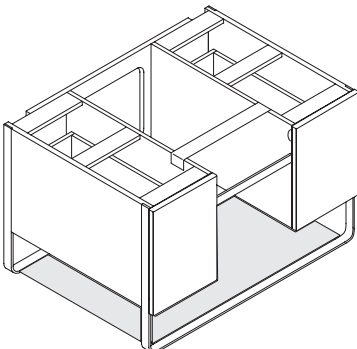

Traverse™ Vanity

A modern interpretation of the flat top trunk of the early 1900s, the Traverse wall-mount vanity has exceptional storage capacity with drawer inserts for efficient organization of your toiletries.

Traverse vanity
30" Wall-Hung K-2517
30" x 19" x 21³/₈"

Engineered Wenge or
Engineered Bird's-eye Maple

Wood Finishes
Ostrich (-F59)
Cape (-F60)

Coordinates with:
Traverse lavatory K-2955

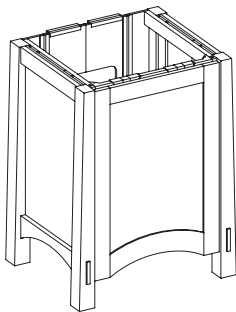

Westmore™ Vanity

Embodying the simplicity and charm of classic American furniture design, the Westmore vanity reflects the precision and master craftsmanship of the Arts and Crafts design movement.

Westwood vanity
24" vanity K-2413
25½" x 21½" x 33½"
30" vanity K-2467
31½" x 21½" x 33½"
36" vanity K-2489
37½" x 21½" x 33½"
48" vanity K-2495
49½" x 21½" x 33½"

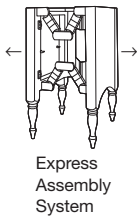

Ailanthus solids and ash veneers

Wood Finish
Westwood (-F41)

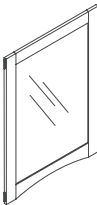

Westwood mirror
K-2504
24" x 33"

Ailanthus solids and Ash veneers

Coordinates with:
Iron/Impressions® cast iron one-piece surface and integrated lavatory

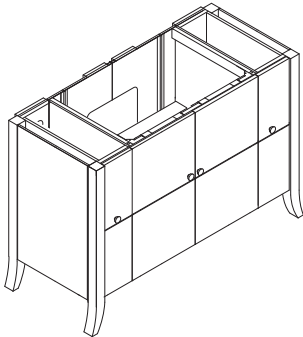

Clermont™ Vanity

The Clermont vanity is carefully crafted to project a subtle elegance. Its façade consists of four grain-matched panels set in a reverse diamond pattern that showcases the handsome character of the wood in an eye-catching manner.

Clermont vanity
24" vanity K-2415
26" x 21½" x 33½"
30" vanity K-2483
32" x 21½" x 33½"
36" vanity K-2491
38" x 21½" x 33½"
48" vanity K-2497
50" x 21½" x 33½"

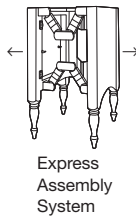

Ailanthus solids and quarter sawn ash veneers

Wood Finish
Oxford (-F39)

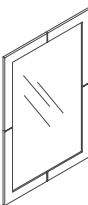

Clermont mirror
K-2509
24" x 33"

Ailanthus solids and quarter-sawn Ash veneers

Coordinates with:
Iron/Impressions cast iron one-piece surface and integrated lavatory

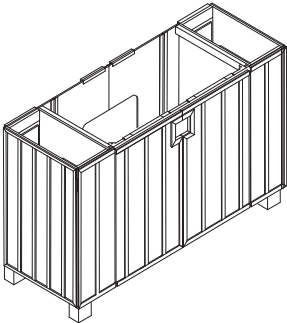

Chalkstripe™ Vanity

With their crisp, clean white design lines, Chalkstripe vanities infuse a modern sensibility into traditional environments.

Chalkstripe vanity
24" vanity K-2414
24" x 21½" x 33½"
30" vanity K-2474
30" x 21½" x 33½"
36" vanity K-2490
36" x 21½" x 33½"
48" vanity K-2496
48" x 21½" x 33½"

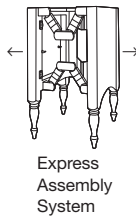

Birch solids and paintable substrate

Wood Finish
Fleece (-F42)

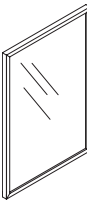

Chalkstripe mirror
K-2508
24" x 33"

Birch solids and paintable substrate

Coordinates with:
Iron/Impressions cast iron one-piece surface and integrated lavatory

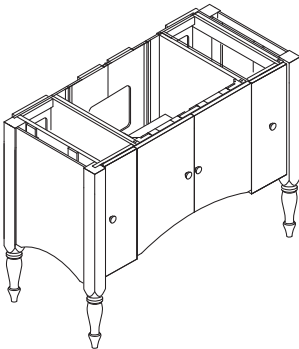

Alberry™ Vanity

Evoking the cherished feel of an heirloom antique, the Alberry vanity takes its design cues from much-admired Colonial furnishings. Its well-built, solid nature, straightforward door lines and arched base epitomize this early American style.

Alberry vanity
24" vanity K-2412
24" x 21½" x 33½"
30" vanity K-2463
30" x 21½" x 33½"
36" vanity K-2488
36" x 21½" x 33½"
48" vanity K-2494
48" x 21½" x 33½"

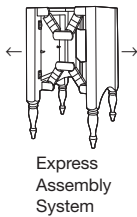

Birch solids and paintable substrate

Wood Finish
Cinder (-F40)

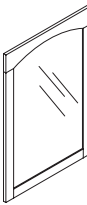

Aberry mirror
K-2503
24" x 33"

Birch solids and paintable substrate

Coordinates with:
Iron/Impressions® cast iron one-piece surface and integrated lavatory

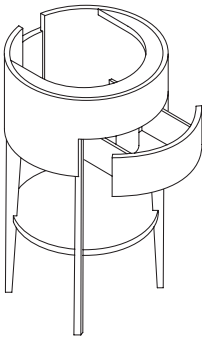

Camber® Petite Vanity

The Camber console-style petite vanity is crafted from select Maple hardwoods and veneers and is offered in a choice of three finish options: Black Forest, Sapele, and Natural Maple. Along with the Camber lavatory, this combination is a creative option for both bath and powder rooms.

Camber petite vanity
K-3002
20⅝" diameter x 34" high

Maple hardwoods and veneers

Wood Finishes
Black Forest (-F2)
Natural Maple (-F3)
Sapele (-F25)

Coordinates with:
Camber lavatory **K-2282**

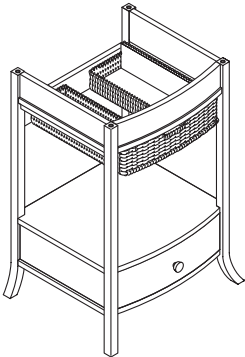

Archer™ Petite Vanity

The Archer transitional design appeal, inspired by craftsman furniture and faceted jewels, is a versatile choice that complements a wide range of décor.

Archer petite vanity
K-2449
24" x 20⅞" x 35"

Maple solids and veneers

Wood Finish
Black Forest (-F2)

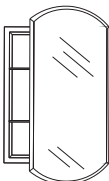

Archer mirror
K-3073
24" x 31" x 5"

Coordinates with:
Archer lavatory **K-2355**
Archer lavatory **K-2356**

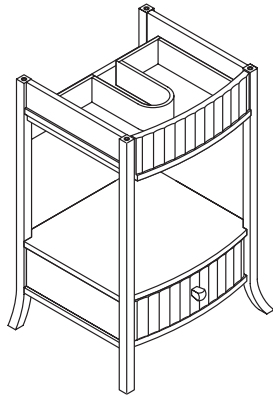

Kelston™ Petite Vanity

Fluid. Simple. Natural. The Kelston Ensemble pairs the sun-drenched nonchalance of a seaside villa with a lightly contemporary design appeal. The petite vanity features fully extendable upper and lower drawers characterized by their fluted exteriors and coordinates beautifully with the self-rimming or undercounter lavatory.

Kelston petite vanity
K-2515
20³/₈" x 17⁵/₈" x 32³/₄"

Hardwood solids
and veneers

Wood Finishes
Black Forest (-F2)
Lily (-F44)
Saddle (-F45)

Coordinates with:
Kelston lavatory **K-2381**

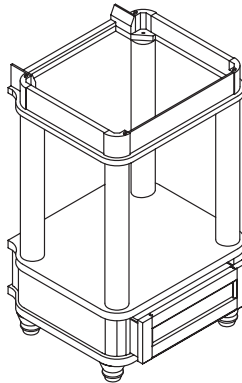

Bancroft® Petite Vanity

The Bancroft aesthetic reflects 1900s American design, where traditional elements lend elegance and grace.

Bancroft petite vanity
K-2461
24" x 21" x 35¹/₄"

Birch solids
and veneers

Wood Finish
Black Forest (-F2)

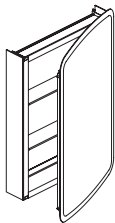

Bancroft mirror
K-CB-CLC2031BAN
20" x 21" X 5"

Silver Aluminum

Coordinates with:
Bancroft lavatory **K-2340**

Fountainhead™

In both form and function, the Fountainhead Collection of bathroom furniture offers enhanced versatility and personalization. Both the vanity and double vanity offer generous storage solutions for all your personal and grooming items and come in two distinct wood finishes – Blanche Maple and Truffle Ash. The Fountainhead furniture line also includes a petite vanity, a swivel vanity seat, wall cabinet and shelf, along with an anglepoise mirror.

Fountainhead dressing vanity
K-2436
69" x 21" x 31"

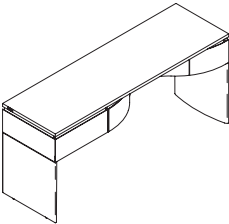

Fountainhead swivel vanity seat
K-2438
14⁹/₁₆" x 18¹/₂"



Fountainhead double vanity
K-2437
60" x 21" x 31"

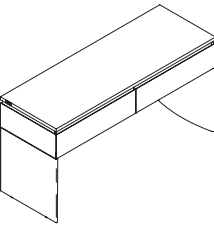

Fountainhead wall cabinet*
K-2432 (shown)

K-2431 No faucet drilling
21" x 36" x 8³/₄"
(33" x 36" with side doors extended)

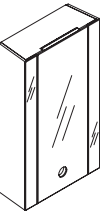

*requires **K-2443-4** Fountainhead integral laminar faucet

Fountainhead petite vanity
K-2435
21" x 21" x 31"

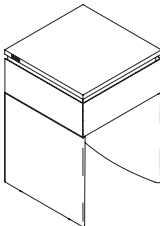

Fountainhead shelf
with faucet drilling*
K-2440
21" x 3⁷/₈" x 8"

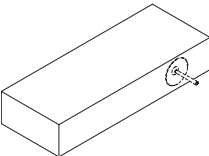

*requires **K-2443-4** Fountainhead integral laminar faucet

Natural maple or ash solids and veneers

Wood Finishes
Blanche Maple (-F34)
Truffle Ash (-F35)

Coordinates with:
Fountainhead Vessels lavatory **K-2352**
Fountainhead Vessels lavatory **K-2834-P5**
Fountainhead Vessels lavatory **K-2829-P5**

Escale®

The coordinating products of the Escale Suite provide the opportunity to create a completely customized bathroom with a refined, modern feel. All plumbing products are available in White, Biscuit and Almond colors, and the furniture is offered in beautiful Engineered Wenge wood.

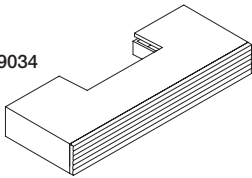
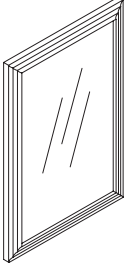
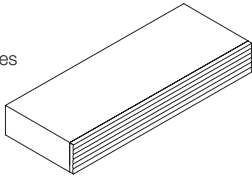
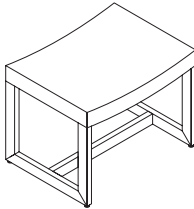
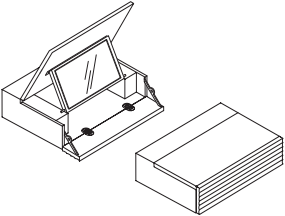
| | |
|---|---|
| <p>Escale vanity with cutout for Escale vanity top and basin K-19034 K-18598 48" x 18" x 7"</p>  | <p>Escale mirror K-18595 26" x 38"</p>  |
| <p>Escale vanity for Vessels lavatories K-18599 48" x 18" x 7"</p>  | <p>Escale bench K-18596 24" x 18" x 18"</p>  |
| <p>Escale makeup vanity K-18597 24" x 18" x 7"</p>  | |

Engineered Wenge solids
and veneers

Wood Finish
Engineered Wenge (-F29)

Coordinates with:
Escale Vessels lavatory **K-19047**
Escale vanity top and basin **K-19034-1**
Escale lavatory **K-19029**

Purist®

Purist lavatories, natural lavastone countertops, mirrored cabinets and bathroom furniture are modularly designed to offer maximum storage and sleek styling, no matter what the size of the space.

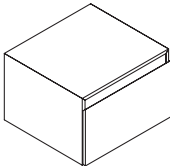
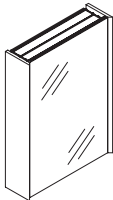
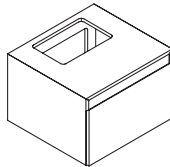
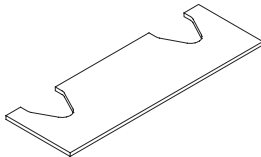
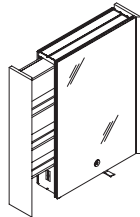
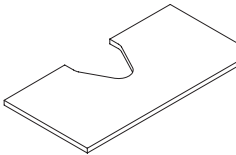
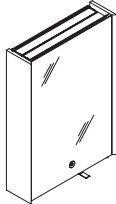
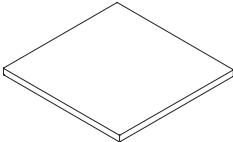
| | |
|--|--|
| <p>Purist wall-mount cabinet K-3080 24" x 22½" x 16"</p> <p>Purist wall-mount vanity Notched for plumbing K-3081 24" x 22½" x 16"</p>  | <p>Purist 24" mirrored cabinet and end cap kit Hinge left K-3090 (shown)</p> <p>Hinge right K-3089 24" x 36"</p> <p>Also available as 12" mirrored cabinet Hinge left K-3083 Hinge right K-3082 12" x 36"</p> <p>End cap Kit K-3094</p>  |
| <p>Purist wall-mount vanity Notched for plumbing K-3081 24" x 22½" x 16"</p>  | <p>Purist natural lavastone 72" countertop cut out for two lavatories (left and right side) K-3034 (shown)</p> <p>Cut out for center lavatory K-3033 72" x 24"</p> <p>Natural grey lavastone</p>  |
| <p>Purist mirrored cabinet with laminar faucet, left-hand shelf extension and GFCI outlet K-3093 (shown)</p> <p>Right-hand shelf extension K-3092 25½" x 36" (45½" x 36" fully extended)</p>  | <p>Purist natural lavastone 48" countertop cut out for center lavatory K-3007 (shown) 48" x 24"</p> <p>Cut out for right-side lavatory K-3031</p> <p>Cut out for left-side lavatory K-3032</p> <p>Natural grey lavastone</p>  |
| <p>Purist mirrored cabinet and end cap kit with laminar faucet K-3091 24" x 36"</p> <p>End cap Kit K-3094</p>  | <p>Purist natural lavastone 24" countertop K-3021 24" x 23½"</p> <p>Natural grey lavastone</p>  |

Hardwood veneers

Wood Finish
Black Walnut (-F4)
White Oak (-F5)

Coordinates with:
Purist Wading Pool™ lavatory **K-2313**
Purist Wading Pool™ lavatory **K-2335**
Purist Wading Pool™ lavatory **K-2334**
Purist Wading Pool™ lavatory **K-2314**

Mirrored Cabinetry

Mirrored cabinetry by Kohler provides modern elegance and optimized functionality. An array of styles and sizes complements the design scheme and spatial parameters of any bathroom, and top-quality construction ensures years of dependable performance.

Fountainhead™ wall cabinet
K-2432* (shown)

K-2431* No faucet drilling
21" x 36" x 83/4"
(33" x 36" with side doors extended)

Wood Finishes
Blanche Maple (-F34)
Truffle Ash (-F35)

*Requires **K-2443-4** Fountainhead
integral laminar faucet

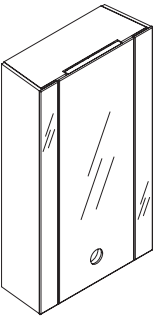

20" Devonshire®
White-enameled mirrored
cabinet with mirrored interior
K-CB-CLW2030DAW
20" x 30" x 5 5/8"

Devonshire single
light sconce in
Brushed Chrome
K-10570-G

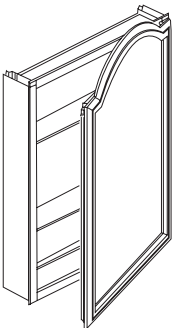

Purist® mirrored cabinet with laminar
faucet, left-hand shelf extension and
GFCI outlet
K-3093 (shown)

Right-hand shelf extension **K-3092**
25 1/2" x 36"
(45 1/2" x 36" fully extended)

Purist mirrored cabinet and end cap kit
with laminar faucet
K-3091/K-3094
24" x 36"

End cap Kit **K-3094**

Purist 24" mirrored cabinet
and end cap kit
Hinge left **K-3090** (shown)

Hinge right **K-3089**
24" x 36"

Also available as 12" mirrored cabinet
Hinge left **K-3083**
Hinge right **K-3082**
12" x 36"

End cap Kit **K-3094**

Wood Finishes
Black Walnut (-F4)
White Oak (-F5)

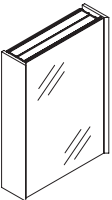
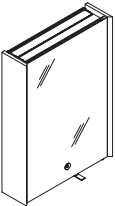
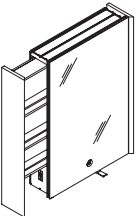

20" decorative Oil-rubbed Bronze-
framed mirrored cabinet with
mirrored interior **K-2967-BR1**
20" x 26" x 5 5/8"

20" decorative Silver-framed
mirrored cabinet with mirrored
interior **K-CB-CLW2026SS**
20" x 26" x 5 5/8"

Also available: 15" decorative
Silver-framed mirrored cabinet
K-CB-CLW1526SS
15" x 26" x 5 5/8"

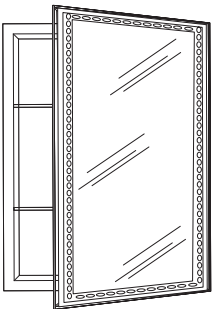

20" Vintage® mirrored cabinet
with mirrored interior
K-CB-CLC2030VAS
20" x 30" x 5"

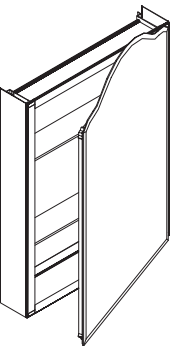

20" arch-top mirrored cabinet
with mirrored interior
K-CB-CLC2030AS
20" x 30" x 5"

Also available:
15" arch-top mirrored cabinet
with mirrored interior
K-CB-CLC1530AS
15" x 30" x 5"

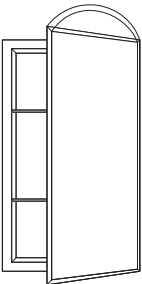

35" double-door mirrored
cabinet with mirrored interior
K-CB-CLC3526FS
35" x 26" x 5"

30" double-door mirrored
cabinet with mirrored interior
K-CB-CLC3026FS
30" x 26" x 5"

25" double-door mirrored
cabinet with mirrored interior
K-CB-CLC2526FS
25" x 26" x 5"

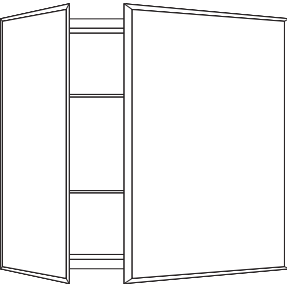

20" Archer™ mirrored cabinet with
mirrored interior **K-3073-NA**
20" x 31" x 5"

Also available:
Transitional single light sconces
in Polished Chrome **K-11365-CP**

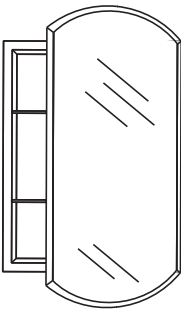

20" mirrored cabinet with
mirrored interior
K-CB-CLC2026FS
20" x 26" x 5"

15" mirrored cabinet with
mirrored interior
K-CB-CLC1526FS
15" x 26" x 5"

16" mirrored cabinet with
mirrored interior*
K-CB-CLR1620FS
16" x 20" x 5"

*Recess install only

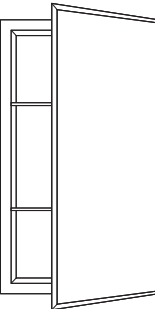

20" Bancroft® mirrored cabinet
with mirrored interior
K-CB-CLC2031BAN
20" x 31" x 5"

Also available:
Transitional single light sconces in
Polished Chrome **K-11365-CP**

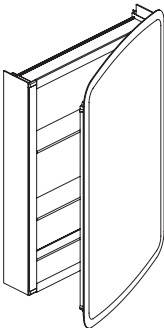

20" oval mirrored cabinet
with mirrored interior
K-2962-NA

20" oval mirrored cabinet
K-CB-CLR20310W

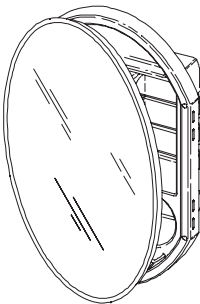

Engineered for the Bathroom

KOHLER® bathroom furniture is available in a wide array of gorgeous finishes and features industry-leading catalyzed polyurethane topcoats manufactured to withstand the harsh temperatures and humidity changes common to the bathroom environment. And they are rigorously tested to ensure longlasting durability.



KOHLER.com